

**Terminal to Terminal Insulators**

Part Number	Sta-Lok Number	Wire Size	Breaking Load	Overall Length	Overall Diameter	Price
SLIN07	143-55	7/32	9000	7-1/2	1-3/8	234.64
SLIN08	143-06	1/4	9000	7-1/2	1-3/8	234.64
SLIN09	143-07	9/32	15000	8	1-1/2	271.85
SLIN10	143-08	5/16	15000	8	1-1/2	283.68
SLIN12	143-10	3/8	21900	9	1-5/8	376.48
SLIN14	143-11	7/16	29607	11-3/16	2	563.10
SLIN16	143-12	1/2	29607	11-3/16	2	563.10



Insulated standing rigging provides an ideal antenna for radio transmission and reception. A Sta-Lok insulator consists of a stainless steel assembly embedded in a black weatherproof nylon injection molding designed to exceed the breaking load of the backstay.

**Impedance Measurement at 15 MHz.**

**Capacitance 16pF Resistance 400 K.**

**D.C. LEAKAGE RESISTANCE at 30 kV - Greater than 10G Ohms.**

**VOLTAGE PROOF TEST - Withstands 30 kV applied for two hours without breakdown.**

**No change in 15 MHz impedance after voltage proof test.**

**For dimensions of end fittings, fork and eye, refer to the appropriate Sta-Lok Terminals.**

**Insulator Body Only**

Part Number	Sta-Lok Number	Wire Size	Breaking Load	Price \$
SLINB07	206-55	7/32	9000	176.29
SLINB08	206-06	1/4	9000	176.29
SLINB09	206-07	9/32	15000	204.46
SLINB10	206-08	5/16	15000	204.46
SLINB12	206-10	3/8	21900	259.04
SLINB14	206-12	7/16	29607	296.44
SLINB16	206-12	1/2	29607	296.44



**Configure your custom insulator using different terminal parts and an adaptor screw.**

**Fork End Only**

Part Number	Sta-Lok Number	Wire Size	Wire Size MM	Pin Size	Price
SLFE0714	210-55	7/32	6	7/16	48.41
SLFE0814	210-06	1/4	6	7/16	48.41
SLFE0914	210-07	9/32	7	7/16	53.39
SLFE1016	210-08	5/16	8	1/2	67.53
SLFE1220	210-10	3/8	10	5/8	96.54
SLFE1424	210-11	7/16	11	3/4	233.35



Pin Included

**Eye End Only**

Part Number	Sta-Lok Number	Wire Size	Wire Size	Pin Size	Price \$
SLEE0812	209-06-3/8	7/32	6 mm	3/8	32.07
SLEE0816	209-06	7/32	6 mm	1/2	32.07
SLEE0916	209-07	9/32	7 mm	1/2	35.65
SLEE1016	209-08-1/2	5/16	8 mm	1/2	44.06
SLEE1020	209-08-5/8	5/16	8 mm	5/8	48.95
SLEE1220	209-10	3/8	10 mm	5/8	64.49
SLEE1424	209-11	7/16		3/4	145.74
SLEE1624	209-12	1/2		3/4	145.74

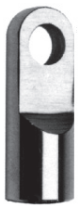

**Adaptor Screw**

Part Number	Sta-Lok Number	Wire Size	Wire Size	Price \$
SLAS07	207-55	7/32	6 mm	7.04
SLAS08	207-06	1/4	6 mm	7.04
SLAS09	207-07	9/32	7 mm	10.61
SLAS10	207-08	5/16	8 mm	10.61
SLAS12	207-10	3/8	10 mm	14.91
SLAS14	207-11	7/16	12 mm	28.77
SLAS16	207-12	1/2		28.77



**Connectors**

Part Number	Sta-Lok Number	Wire Size	A	B	Body Diameter	Price
SLSC05	172-04	5/32	2-11/32	1-7/16	1/2	48.41
SLSC06	172-05	3/16	2-27/32	1-11/16	5/8	53.44
SLSC07	172-55	7/32	3-3/8	2-1/8	3/4	68.33
SLSC08	172-06	1/4	3-3/8	2-1/8	3/4	68.33
SLSC09	172-07	9/32	3-7/8	2-3/8	7/8	82.14
SLSC10	172-08	5/16	4-7/32	2-1/2	1	98.92
SLSC12	172-10	3/8	5-1/16	2-7/8	1-1/8	144.32
SLSC14	172-11	7/16	6-1/8	3-5/8	1-3/8	307.94
SLSC16	172-12	1/2	6-1/8	3-5/8	1-3/8	307.94

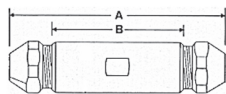

**STA-LOK connectors are useful for joining two pieces of wire. This can become necessary in making emergency repairs in cases of chafe or damage to the wire.**

**Terminal End (includes 1x19 wedge and former)**

Part Number	Sta-Lok Number	Wire Size	Price
SLTE07	211-55	7/32	29.24
SLTE08	211-06	1/4	29.24
SLTE09IN*	227-07	9/32	39.13
SLTE10	211-08	5/16	39.13
SLTE12	211-10	3/8	58.83
SLTE14	211-11	7/16	133.35
SLTE16	211-12	1/2	133.35



\*Fits 5/16 Body